



# SERIES: HS

**Carbon Steel**  
**Screw Connect**  
**Heavy Duty**

## Product Features

- Screw poppet valve
- Connectable up to 33% of working pressure with tools
- Self-locking connecting thread
- Black O-Ring - External O-ring as a safety feature to indicate the complete/correct connection of the male tip and female body (the O-ring must be covered by the sleeve of the female body)

## Technical Features

Material	Carbon Steel
Surface Finishing	Zinc-Plating and Thick-Film-Passivation (Chrome III)
Standard Seal	NBR (Buna-N®) Other materials available on request
Working Temperature	-25° C ... +100° C / -13° F ... +212° F
Connection	Screw
Disconnection	Screw
Connect Under Pressure	Male Tip/Female Body up to 33% of the working pressure with tools
Application	Construction Machinery
ISO Interchange	ISO 14541 (BG 1-6)

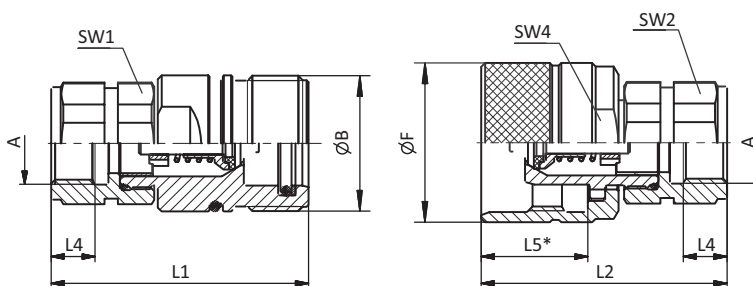

SW: Width across flats. All dimensions in mm  
\* Insertion Female Body.

## Dimensions (mm)

Nominal Size	Port A	ØB	ØF	L1	L2	L4 min	L5	SW1	SW2	SW4	Female Body Weight kg	Male Tip Weight kg
6.3	G1/4"	M24x2	30	59.1	58	12	25.1	19	19	27	0.122	0.130
10	G3/8"	M28x2	34	64.5	62	12	26.5	22	22	30	0.163	0.174
12	G1/2"	M36x2	41.8	67	63	12	28	30	30	38	0.312	0.281
19	G3/4"	M42x2	48	82	75	16	21	36	36	41	0.511	0.441
25	G1"	M48x3	55	95	78.5	18	35.5	41	18	50	0.713	0.615
38	G1 1/4"	M70x3	80	116	121	20	44	60	20	65	1.802	2.350

## Technical Data

Series	DN Inch	DN ISO 4397		Q max l/min	Working Pressure		Bursting Pressure				Spillage ml	
		mm	bar		Connected		Female Body		Male Tip			
					bar	PSI	bar	PSI	bar	PSI		
HS-06	1/4	6.3	20	450	6527	1800	26107	1400	20305	1400	20305	0.8
HS-10	3/8	10	35	450	6527	1600	23206	1750	25382	1550	22481	1.3
HS-12	1/2	12.5	80	400	5801	1400	20305	1200	17404	1200	17404	3.1
HS-19	3/4	19 (20)	120	400	5801	1500	21756	1600	23206	1200	17404	5.6
HS-25	1	25	160	300	4351	1180	17114	1500	21756	1100	15954	12.3
HS-38	1 1/4	38	220	350	5076	1800	26107	1600	23206	1200	17404	52.3

The indicated pressure ratings only apply to the coupling itself and depend on the connection type.

# SERIES: HS

Carbon Steel  
Screw Connect  
Heavy Duty



QUICK CONNECT COUPLINGS

Article no.	Description	Price £	Price €
720001	Screw Poppet Female 06 Body 1/4" BSPF	£21.70	€22.80
720002	Screw Poppet Male 06 Body 1/4" BSPF	£20.90	€22.00
720003	Screw Poppet Female 10 Body 3/8" BSPF	£21.50	€22.60
720004	Screw Poppet Male 10 Body 3/8" BSPF	£23.60	€24.80
720005	Screw Poppet Female 12 Body 1/2" BSPF	£21.50	€22.60
720006	Screw Poppet Male 12 Body 1/2" BSPF	£23.20	€24.30
720007	Screw Poppet Female 19 Body 3/4" BSPF	£46.80	€49.10
720008	Screw Poppet Male 19 Body 3/4" BSPF	£48.50	€51.00
720009	Screw Poppet Female 25 Body 1" BSPF	£52.00	€54.60
720010	Screw Poppet Male 25 Body 1" BSPF	£55.00	€57.70
720011	Screw Poppet Female 38 Body 1 1/4" BSPF	£259.20	€272.20
720012	Screw Poppet Male 38 Body 1 1/4" BSPF	£283.50	€297.70

## SERIES: HS - DUST PROTECTION

### Dust Cap for Female Body

Size	D1	D2	L	Material	Article no.	Price £	Price €
6	M24x2	19	180	Plastic Red - Standard	HS06MR	£4.80	€5.80
10	M28x2	23	180		HS10MR	£5.30	€6.40
12	M36x2	29.5	185		HS12MR	£3.50	€4.20
19	M42x2	36.5	190		HS19MR	£4.20	€5.00
25	M48x3	41	190		HS25MR	£3.70	€4.40
38	M70x3	55	201		HS38MR	£12.10	€14.60

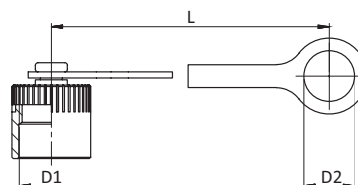

### Dust Plug for Male Tip

Size	D1	D2	L	Material	Article no.	Price £	Price €
6	M24x2	19	180	Plastic Red - Standard	HS06FR	£4.80	€5.80
10	M28x2	23	180		HS10FR	£5.30	€6.40
12	M36x2	29.5	185		HS12FR	£3.50	€4.20
19	M42x2	36.5	190		HS19FR	£4.20	€5.00
25	M48x3	41	190		HS25FR	£3.70	€4.40
38	M70x3	55	201		HS38FR	£12.10	€14.60

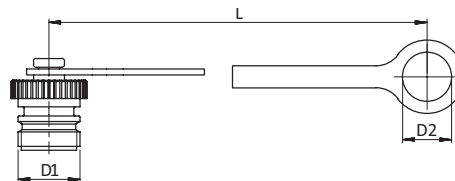

In addition to the standard colours as stated above, plastic dust caps are also available in blue, green, yellow and black.