



parking station for female body

SERIES: BP

Carbon Steel Trailer Brake

Product Features

- Flat Face
- Integrated locking system preventing unintentional release of the coupling
- ISO Interchange acc. to ISO 5676
- Female body is supplied with a parking station
- Male tip can be panel mounted

Technical Features

Material	Carbon Steel
Surface Finishing	Zinc-Nickel
Standard Seal	NBR (Buna-N®), PTFE. Other materials available on request
Working Temperature	-25° C ... +100° C / -13° F ... +212° F
Connection	Push and actuate Push Sleeve
Disconnection	Actuate Push Sleeve
Connect Under Pressure	Not allowed
Application	Agricultural and Forestry Machinery

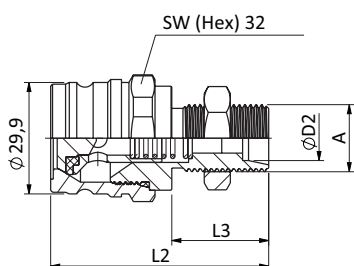
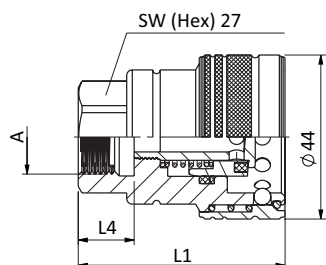

SW: Width across flats. All dimensions in mm

Article no.	Description	Price £	Price €
790001	Flat Face Female 12 Body 3/8" BSPF		
790002	Flat Face Female 12 Body 1/2" BSPF		
790003	Flat Face Female 12 Body M18x1.5 F		
790004	Flat Face Male 12 Body 1/2" BSPF		
790005	Flat Face Male 12 Body 12L		
790006	Flat Face Male 12 Body 15L		

Dimensions (mm)

	Port A	ØD2	L1	L2	L3	L4	Weight kg
Female Thread according to DIN 3852 - ISO 1179-1	G1/2"		55.5			15	0.336
	M18x1.5		55.5			15	0.343
Male Thread with 24° Conical Bore - Bulkhead - Shape W according to DIN 3861	M18x1.5	12L		55.8	26		0.177
	M22x1.5	15LB		60.5	28		0.203

Technical Data

Series	DN	DN	Q max	Working Pressure		Bursting Pressure			Spillage			
						Connected		Female Body			Male Tip	
ISO 4397			l/min	bar	PSI	bar	PSI	bar	PSI	ml		
Inch	mm											
BP-12	1/2	12.5	35.5	150	2175	1000	14504	620	8992	900	13053	0.05

The indicated pressure ratings only apply to the coupling itself and depend on the connection type.

SERIES: BP - DUST PROTECTION

Dust Cap for Male Tip

Size	D1	D2	L	Material	Article no.	Price £	Price €
12.5	30	29.5	185	Plastic (Red - Standard)	BP12MR	£2.00	€2.50

Dust Plug for Female Body

Size	D1	D2	L	Material	Article no.	Price £	Price €
12.5	29	29.5	185	Plastic (Red - Standard)	BP12MA		

