

INLINE BALL VALVE WITH SPRING RETURN HANDLE

(DEAD MANS LEVER)

2000 PSI Rated - 1/4" to 1"

1000 PSI Rated - 1 1/2" to 2"

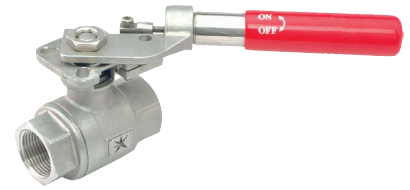

Article no.	Size BSP PARALLEL	Max Pressure BAR	Valve bore	Price £	Price €
411592	1/4"	140	11.2	£123.20	€147.80
411593	3/8"	140	12.5	£123.20	€147.80
411594	1/2"	140	15.0	£140.50	€168.60
411595	3/4"	140	20.0	£165.40	€198.40
411596	1"	140	25.0	£217.80	€261.40
411597	1 1/2"	70	38.0	£332.10	€398.50
411598	2"	70	50.0	£456.20	€547.40

NPT AVAILABLE ON REQUEST

Materials

Body	Investment Cast S/S CF8M (316)
Ball	316 S/S - Mirror Finish
Stem Seal	PTFE
Ball Seal	RTFE
Temp. Range	-20 to +120°C

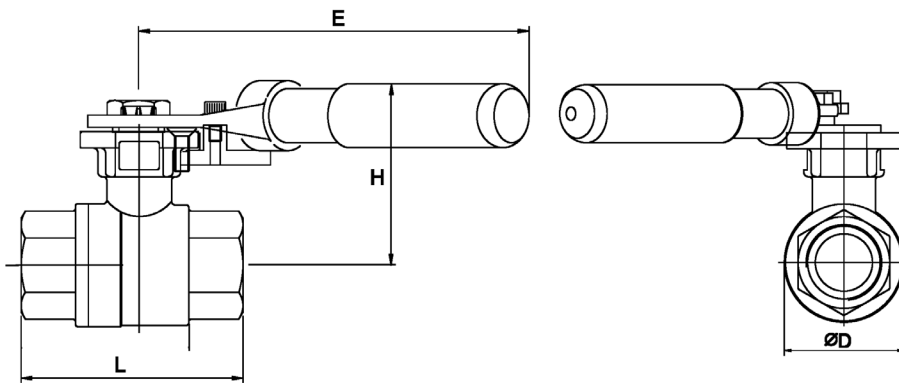

Dimensions (mm)

BSP	E	H	L	ØD	Weight Kg	ISO5211
1/4"	184	29.5	57.0	11.2	0.68	F03/F04
3/8"	184	29.5	57.0	12.5	0.65	F03/F04
1/2"	184	32.7	66.1	15.0	0.81	F03/F04
3/4"	184	36.6	75.6	20.0	0.96	F03/F04
1"	234	45.2	87.2	25.0	1.35	F03/F04
1 1/2"	330	59.5	113.2	38.0	3.18	F05/F07
2"	330	71.3	134.0	50.0	4.38	F05/F07