

Piston Type Accumulators HP Series

Technical Features

- Maximum working pressure (PS): 250 bar
- Test pressure (PT): PS x 1,43
- Working temperature (T): from -20°C to +80°C
- Type:
 - *not reparable for volumes up to 6 litres (D.1)
 - *reparable for volumes from 7 to 80 litres(D.2)
- Construction method: carbon steel body with separation piston made in aluminium
- Seals:
 - standard execution : NBR
 - on request : Polyurethane – FKM – PTFE
- Max speed piston:
 - 0,4 m/s for piston diameter of 60-80-100 mm
 - 0,6 m/s for piston diameter of 150 mm
 - 0,6 m/s for piston diameter of 250 mm
- Assembly: in every position
- Compression Ratio: in the piston execution the compression ratio does not require compliance with strictly defined parameters
- Spare parts :
 - "R" nitrogen valve for capacity up to 6 litres
 - Nitrogen valve and kit seals for piston and end cover for volume from 7 to 100 litres
- Warranty: see dedicated page



ACCUMULATORS

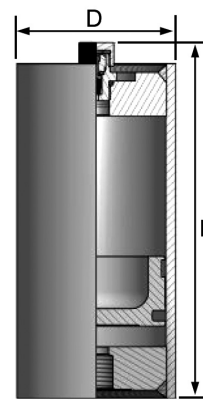

Drawing No 1

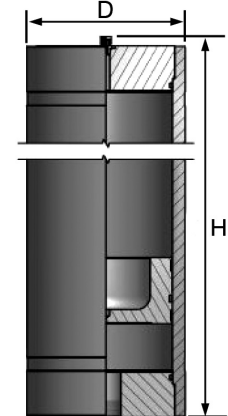

Drawing No 2

Article No.	Max Pressure	Nitrogen Volume	Max N ² precharge	H	D	Piston Diameter	Oil ports	Max Flow	Weight	Drawing	
	bar	Lt	bar	mm	mm	mm	F	Lt/min	Kg	N.	
not reparable - welded cap	250	0,3	175	HP60-0,3	180	70	60	½"BSP	80	3,4	1
				HP60-0,5	260	70	60	½"BSP	80	4	1
				HP80-0,5	200	92	80	½"BSP	120	4,6	1
				HP80-0,7	240	92	80	½"BSP	120	5,8	1
				HP80-1	300	92	80	½"BSP	120	7	1
				HP80-1,5	350	92	80	½"BSP	120	8,2	1
				HP100-1	260	115	100	¾"BSP	180	11	1
				HP100-2	390	115	100	¾"BSP	180	14,2	1
				HP100-3	530	115	100	¾"BSP	180	18	1
				HP100-4	660	115	100	¾"BSP	180	21	1
				HP100-5	790	115	100	¾"BSP	180	25	1
HP100-6	920	115	100	¾"BSP	180	29	1				

reparable - threaded cap	250	7	175	HP150-7	570	175	150	1" BSP	450	38	2
				HP150-10	750	175	150	1" BSP	450	45	2
				HP150-13	930	175	150	1" BSP	450	54	2
				HP180-10				1½"BSP			
				HP180-15	825	207	180	1½"BSP	900	92	2
				HP180-20	1021	207	180	1½"BSP	900	106	2
				HP180-25	1218	207	180	1½"BSP	900	118	2
				HP180-30	1414	207	180	1½"BSP	900	129	2
				HP180-35	1611	207	180	1½"BSP	900	140	2
				HP250-20	764	295	250	2"BSP	1700	198	2
				HP250-30	967	295	250	2"BSP	1700	240	2
				HP250-40	1170	295	250	2"BSP	1700	272	2
				HP250-50	1374	295	250	2"BSP	1700	294	2
				HP250-60	1578	295	250	2"BSP	1700	338	2
				HP250-80	1986	295	250	2"BSP	1700	386	2
				HP250-100	2363	295	250	2"BSP	1700	460	2
				HP350-150	1850	406	350	2"BSP	2000	860	2
				HP350-250	2890	406	350	2"BSP	2000	1200	2

Price

PRICE ON REQUEST

please contact our sales team for a quote on your next accumulator project

**sales@isisfluid.com
01608 645755**

PRICE ON REQUEST

please contact our sales team for a quote on your next accumulator project

**sales@isisfluid.com
01608 645755**