

# Needle Valves – Single Acting Flow Control with Free Reverse Flow NDRV Series

**350 BAR Rated**

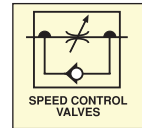

FLOW CONTROL VALVES



Article no.	Size BSP	Max Pressure BAR	Max Flow Controlled LPM	Max Flow Reverse LPM	Price £	Price €
9204001	1/8"	350	10	15	£67.10	€69.20
9204002	1/4"	350	50	70	£41.40	€42.70
9204003	3/8"	350	75	100	£48.20	€49.70
9204004	1/2"	350	140	150	£64.20	€66.20
9204005	3/4"	350	175	200	£79.20	€81.60
9204006	1"	350	350	275	£178.40	€184.00
9204007	1 1/4"	350	350	400	£273.40	€281.90
9204008	1 1/2"	350	350	520	£306.30	€315.90
9204009	2"	350	350	600	£440.60	€454.30

## Panel Mounting Nuts – STEEL

Article no.	Size	Price £	Price €
10095	1/4" & 3/8"	£7.10	€7.30
10096	1/2" & 3/4"	£6.90	€7.10
10097	1" - 1 1/2"	£6.90	€7.10

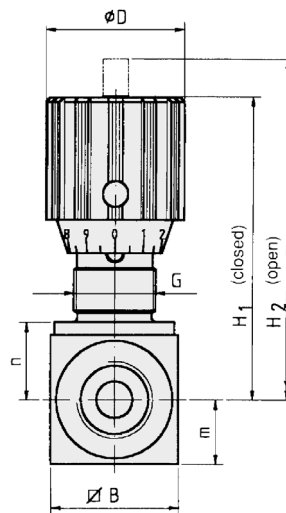
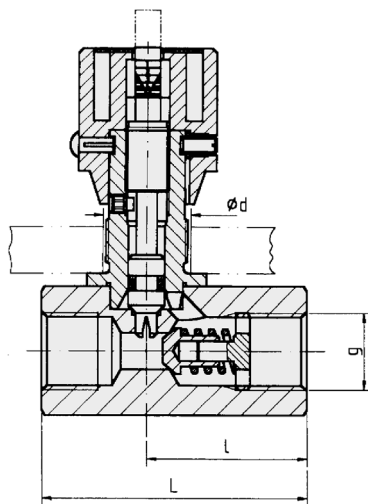

## Materials

Body	Steel 9SMn28K
Stem	Steel
Stem Seal	NITRIL (Others On Request)
Temp. Range	-10 to +100°C
Control Knob	Nylon

## Dimensions (mm)

TYPE	Pn	g	H2	H1	m	n	B	l	L	D	d	G	weight kg
9204001	350	G1/8	60	55	8	10	16	26	45	24	13	Pg7	0.13
9204002	350	G1/4	71	65	12.5	14.5	25	33.5	55	29	19	Pg11	0.30
9204003	350	G3/8	75	68	15	17	30	41	65	29	19	Pg11	0.45
9204004	350	G1/2	92	82	17.5	21	35	44	73	38	23	Pg16	0.80
9204005	350	G3/4	106	96	22.5	26	45	57	88	38	23	Pg16	1.30
9204006	350	G1	149	132	25	30	50	77	127	55	38	Pg29	2.40
9204007	350	G1 1/4	154	137	30	35	60	93	143	55	38	Pg29	3.50
9204008	350	G1 1/2	159	142	35	40	70	91	143	55	38	Pg29	4.60
9204009	350	G2	169	152	45	50	90	111	165	55	38	Pg29	7.70