

Series BP • Carbon Steel
Product Description

Push-to-Connect couplings of the BP Series from STAUFF consist of a male tip and a female body which are used for quick and easy connection (push) and disconnection of tubes, pipes and hoses by hand, i.e. without tools.

The Series was developed according to ISO 5676 in the nominal size 12,5 (1/2").

The proven design is suitable for use in hydraulic braking systems of tractors and trailers.

Features

- Flat Face
- Coupling made from carbon steel with Zinc/Nickel surface coating
- Integrated locking system preventing unintentional release of the coupling
- ISO Interchange acc. to ISO 5676
- Female body is supplied with a parking station
- Male tip can be panel mounted

Applications

Agricultural and Forestry Machinery



Hydraulic trailers

Top Features

Zinc/Nickel coating



Suitable for panel mounting



Designed for secure connection

BP



parking station for female body



Series BP ▪ Carbon Steel

Material	Carbon Steel
Surface Finishing	Zinc-Nickel
Standard Seal Material(s)	NBR (Buna-N®), PTFE ²
Working Temperature	-25° C ... +100° C / -13° F ... +212° F
Valve Design	Flat Face
Connection	Push and actuate Push Sleeve
Disconnection	Actuate Push Sleeve
Connect Under Pressure	not allowed
Application	Agricultural and Forestry Machinery
ISO Interchange	ISO 5676



²Alternative seal materials are available on request.

Technical Data

Series	BG	DN Zoll	DN metric ISO 4397	Q _{max}		Working Pressure		Bursting Pressure Connected		Female Body		Male Tip		Spillage	
				l/min	US GPM	bar	PSI	bar	PSI	bar	PSI	bar	PSI	ml	fl oz
BP-12	3	1/2"	12,5	34,5	9.11	150	2175	1000	14504	620	8992	900	13053	0,05	.0017

The indicated pressure ratings only apply to the coupling itself and depend on the connection type.

BP

Flow Characteristics

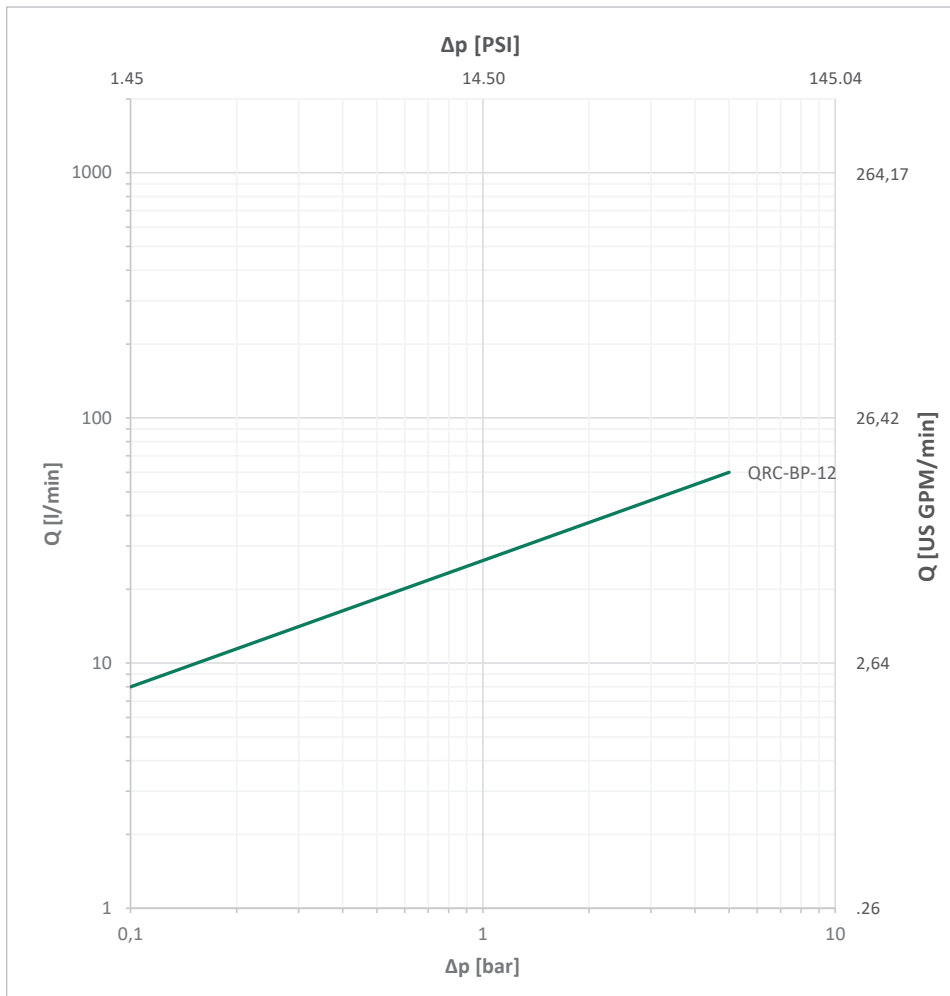

Please note: Unless otherwise stated, all flow characteristics have been determined with hydraulic oil with a kinematic viscosity of 28,8 - 35,2 mm²/s (28,8 - 35,2 cSt) and are only valid for components with non-reducing connections.



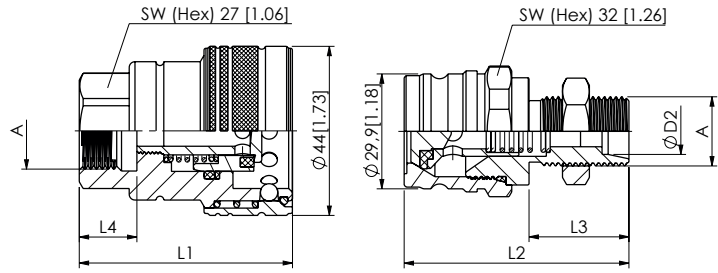

SW: Width across flats. All dimensions in mm (inch).

Series BP-12 ▪ BG 3 ▪ Nominal Size 12,5

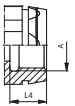
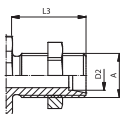
Port A	Dimensions (mm/in)					Female Body* Ordering Codes	Weight (^{kg} /lbs) ca. per 100	Male Tip Ordering Codes	Weight (^{kg} /lbs) ca. per 100
	ØD2	L1	L2	L3	L4				
Female Thread according to DIN 3852 - ISO 1179-1									
	G 1/2"		55,5 2.19			15 .59	QRC-BP-12-FDS-G08-BT-W3	33,65 74.19	
	M18x1,5		55,5 2.19			15 .59	QRC-BP-12-FDS-M180R-BT-W3	34,34 75.71	
Male Thread with 24° Conical Bore - Bulkhead - Shape W according to DIN 3861									
	M18x1,5	12L		55,8 2.20	26 1.02			QRC-BP-12-M-12LB-B-W3	17,76 39.15
	M22x1,5	15LB		60,5 2.38	28 1.10			QRC-BP-12-M-15LB-B-W3	20,31 44.78

* Delivery standard of the female body includes a parking station.

Series BP ▪ Dust Protection

Dimensions (mm/in)			Material	Dust Cap for Male Tip
D1	D2	L		Ordering Codes
30 1.18	29,5 1.16	185 7.28	Plastic (Colour: Red)	QRC-BP-10-DM-30-K-RD

Dimensions (mm/in)			Material	Dust Plug for Female Body
D1	D2	L		Ordering Codes
29 1.14	29,5 1.16	185 7.28	Plastic (Colour: Red)	QRC-BP-10-DF-30-K-RD

Note: The connection of the two halves of a coupling is achieved depending on the type. It is important to observe the positive engagement of plug-type couplings and the secure tightening of screw-type couplings to the limit stop of the thread. Forced or improper separation will result in malfunction of the coupling.

